

# Index

Introduction..... **1**

## Plumbing

Rewashing a dripping tap..... **3**

Clearing a blocked waste ..... **5**

Adjusting a toilet overflow..... **7**

Frozen or burst pipes..... **9**

## Electrics

Wiring a plug..... **11**

Resetting a trip switch ..... **13**

Changing a fluorescent tube or starter ... **15**

Changing a battery in a smoke detector.. **17**

## Doors and cupboards

Adjusting cupboard doors..... **19**

Adjusting a squeaky or loose door ..... **21**

Adjusting a sticking door..... **23**

Replacing a set of handles (or knobs)... **25**

Replacing a mortice latch (internal door).. **27**

## Heating

Setting on/off times

- with a digital programmer ..... **29**

- with a timeclock programmer ..... **31**

Controlling heating temperature ..... **33**

Bleeding a radiator ..... **35**

## Decorating and fixings

Fixing items to walls and doors ..... **37**

Decorating

- preparation..... **39**

- wallpaper stripping..... **41**

- painting..... **43**

## Advice

Effective use of heat..... **45**

Dealing with condensation..... **47**

Care of the home..... **49**

Safety in the home..... **51**

# Changing the battery in a battery-operated smoke detector

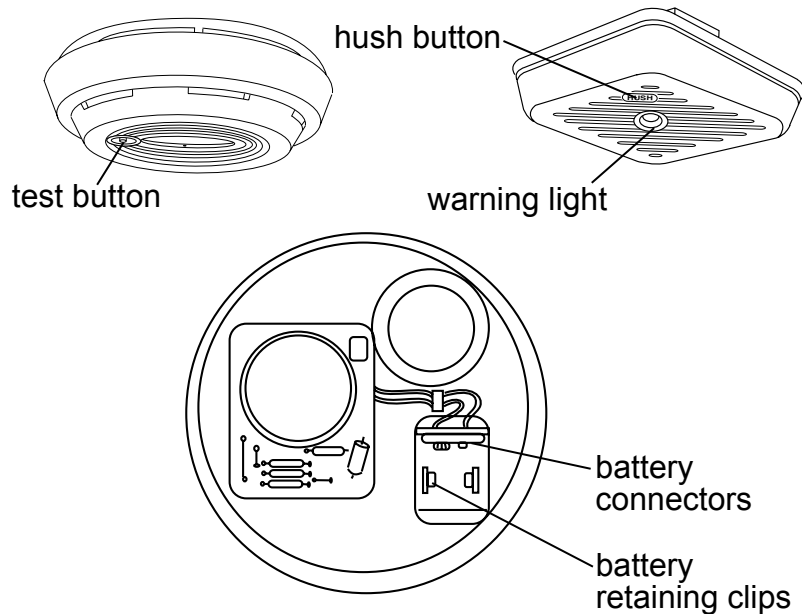

battery operated smoke detectors

## Advice

- Battery operated detectors will beep at intervals if the battery is low.
- Smoke detectors can be battery operated or mains operated. Some mains operated ones have a battery back-up.
- If you have a mains operated detector and the alarm goes off in error, switch off the circuit at the consumer unit. Wait at least 5 minutes before turning the circuit back on.

## You need

- New 9v battery

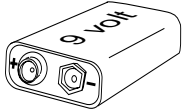

- Step ladder

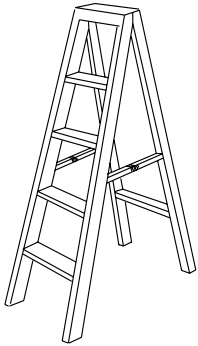

## What to do

(**Note:** If your smoke detector is linked into the electrical wiring in your home **you do not need to change the battery.**)

1. Unclip the cover of the detector.
2. Remove the existing battery from its retaining clips and unclip the connectors.
3. Clip the new battery into the connectors and put it back into the retaining clips.
4. Close the detector and check it by pushing in the test button. The alarm will sound for a short time.

# Adjusting kitchen cupboard doors

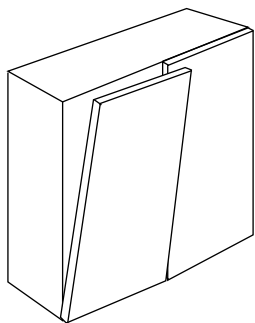

sticks out

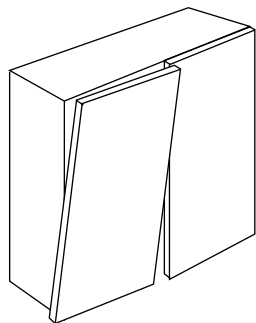

not square

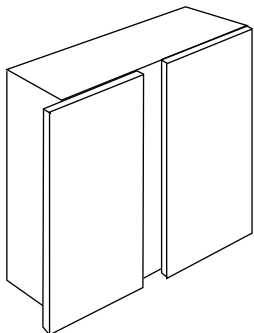

side or middle gap

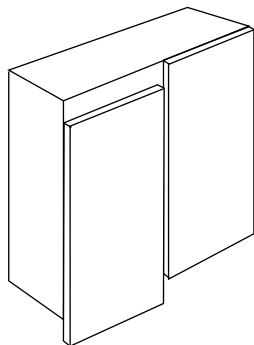

top or bottom gap

## Advice

- You will have either a 90° hinge or a 180° hinge. The instructions are the same for both types, but you need to look at the correct picture below to see where the screws A, B and C are.
- Do all adjustments with the door fully open. It can help if someone else holds the door while you do the adjustments.

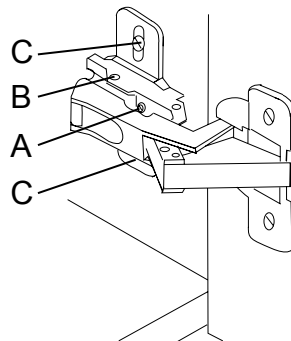

180° hinge

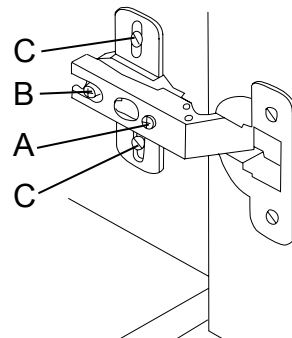

90° hinge

## You need

- Small screwdriver (usually a 'philips' crosshead type)

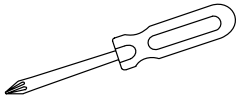

## What to do

### If one door sticks out further from the cupboard than the other

1. Loosen screw B (one turn anti-clockwise) on both the top and bottom hinges.
2. Move the door to the correct position.
3. Tighten screw B on both hinges.

### If doors are not square with the cupboard

1. Turn screw A gradually clockwise or anti-clockwise to lift or drop the door until you get it to the correct position. You may need to loosen screw B a little to allow the door to move.
2. Tighten screws A and B when you have finished.

### If there is a gap where the door meets the cupboard

1. For a gap at the side or middle turn screw A on both hinges by the same amount in the same direction until the door fits correctly.
2. For a gap at the top or bottom loosen screw C on both hinges. Adjust the door until it is in the correct position. Tighten up both screws.